

● A 4 hour fire resistance system.  
Tested to B.S.476 part 22:1987

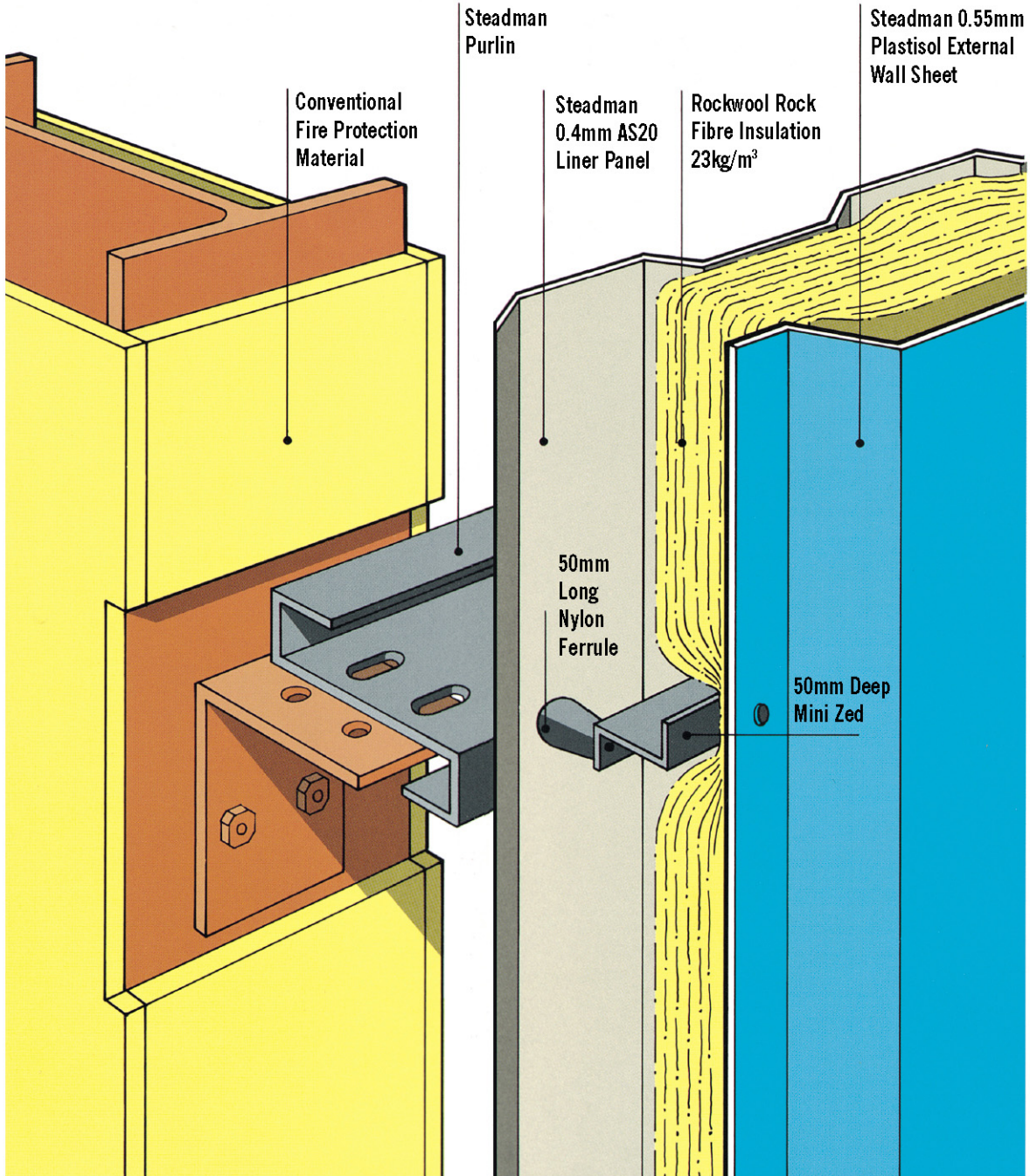

**AS FIRE RESISTANT SYSTEM**

Designed for external non-loading walls the Steadman AS Fire Resistant System incorporates Rockwool Rock fibre insulation. The system, detailed below, has undergone stringent tests at the Warrington Fire Research Centres (WARRES No. 55936).

The tests were successful and satisfied the performance requirements specified in section 5 of BS476 part 22:1987 for non-loadbearing wall construction for the following periods:

**INTEGRITY 245minutes      INSULATION 22 minutes**

As a result the system can resist fire for up to 4 hours

Steadman AS Fire Resistant System is designed as a complete fire protection kit, but is not much more costly than the individual components of a standard non-loadbearing wall. The system can be easily constructed by experienced cladding contractors.





AS

Fire System

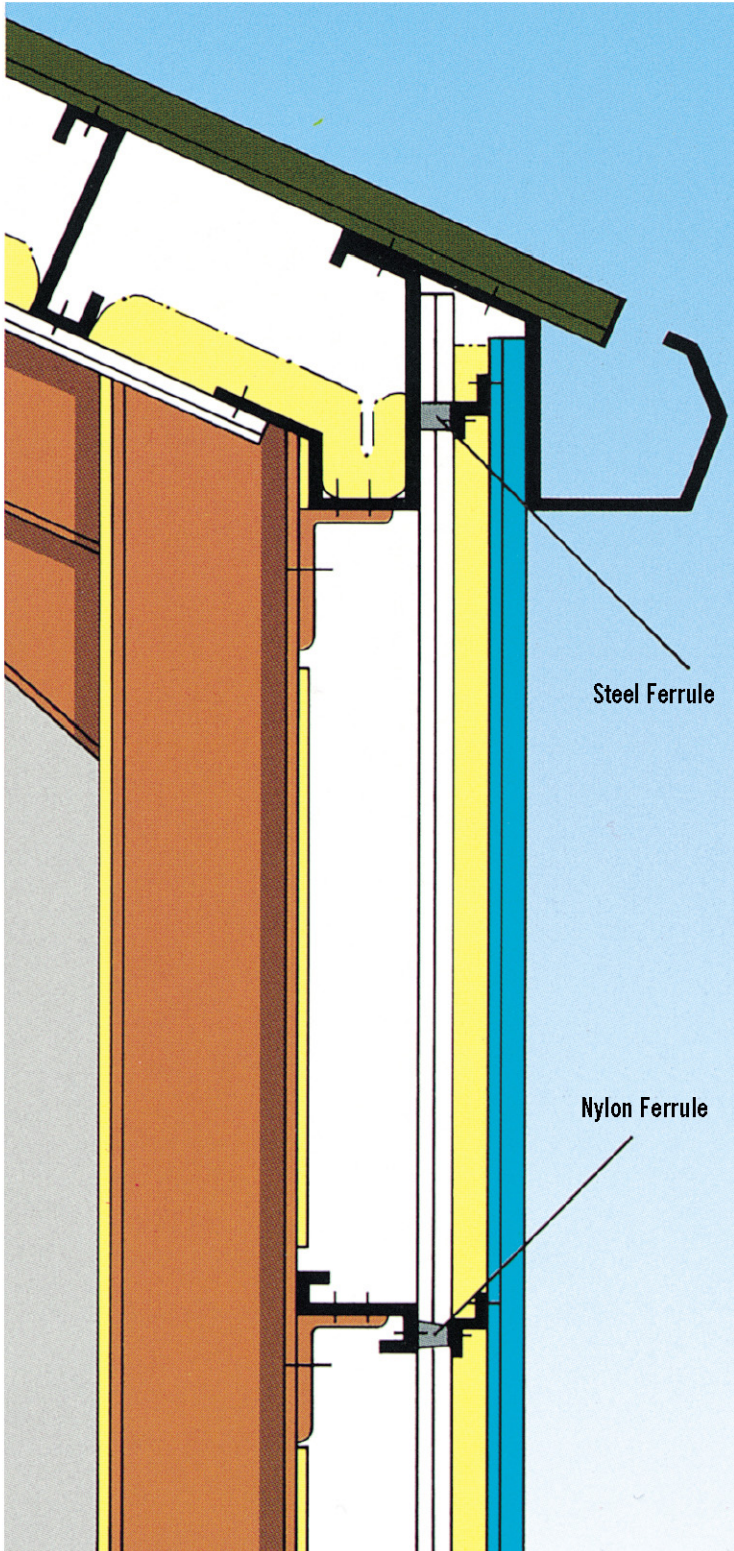

### **FULL STRUCTURAL PROTECTION**

It is essential that the specifications are followed closely. As illustrated (overleaf) the system consists of specified materials and fixings. During the course of a fire, serious damage can be caused by metal expansion; therefore it is important that purlins are 60mm shorter than standard and cleats should have slotted bolt holes and nylon bolt washers.

### **INCREASED INSULATION**

An added benefit to fire protection construction is the increased insulation generated by the specified components.



For further details,  
please contact Steadman's  
Technical Department.